

ADS-1.0/3-1.0/8-1.4

1.0mm Plug To 1.0mm Jack
110GHz VSWR 1.4

50Ω

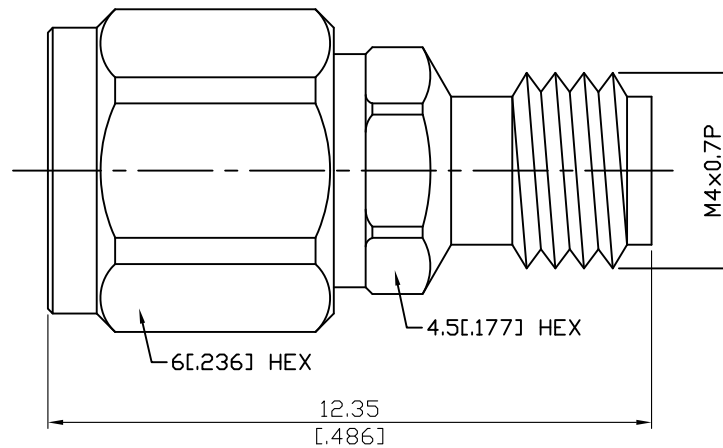

Parts	Material	Plating (Micro-inch)
Body	Stainless Steel	Passivated
Coupling Nut	Stainless Steel	Passivated
Contact Pin	Beryllium Copper	Gold 4 Over Nickel-Phosphorus Alloy 80 Over Copper 20
Insulator	PPO	
Retainer Ring	Beryllium Copper	Tin-Zinc-Copper-Alloy 100 Over Copper 50
Gasket	Silicone	

This part number complies with RoHS.

Notice: JYEBAO reserves the right to make modifications deemed appropriate.

ADS-1.0/3-1.0/8-1.4	1.0mm Plug To 1.0mm Jack 110GHz VSWR 1.4																
<table border="0"> <tr> <td data-bbox="132 342 531 394">Interface</td> <td></td> </tr> <tr> <td data-bbox="132 394 531 488">Standard</td> <td data-bbox="794 394 1481 488">IEC61169-31</td> </tr> </table>		Interface		Standard	IEC61169-31												
Interface																	
Standard	IEC61169-31																
<table border="0"> <tr> <td data-bbox="132 510 531 562">Electrical Data</td> <td></td> </tr> <tr> <td data-bbox="132 562 531 611">Impedance</td> <td data-bbox="794 562 1481 611">50Ω</td> </tr> <tr> <td data-bbox="132 611 531 660">Frequency Range</td> <td data-bbox="794 611 1481 660">DC to 110GHz</td> </tr> <tr> <td data-bbox="132 660 531 710">VSWR</td> <td data-bbox="794 660 1481 710">≤ 1.4(DC to 110GHz)</td> </tr> <tr> <td data-bbox="132 710 531 759">Insulation Resistance</td> <td data-bbox="794 710 1481 759">≥ 5000MΩ</td> </tr> <tr> <td data-bbox="132 759 531 808">Dielectric Withstanding Voltage (at sea level)</td> <td data-bbox="794 759 1481 808">500 V rms, 50Hz</td> </tr> <tr> <td data-bbox="132 808 531 857">Working Voltage (at sea level)</td> <td data-bbox="794 808 1481 857">150 V rms, 50Hz</td> </tr> <tr> <td data-bbox="132 857 531 907">RF Leakage</td> <td data-bbox="794 857 1481 907">≥ 90dB to 1GHz</td> </tr> </table>		Electrical Data		Impedance	50Ω	Frequency Range	DC to 110GHz	VSWR	≤ 1.4(DC to 110GHz)	Insulation Resistance	≥ 5000MΩ	Dielectric Withstanding Voltage (at sea level)	500 V rms, 50Hz	Working Voltage (at sea level)	150 V rms, 50Hz	RF Leakage	≥ 90dB to 1GHz
Electrical Data																	
Impedance	50Ω																
Frequency Range	DC to 110GHz																
VSWR	≤ 1.4(DC to 110GHz)																
Insulation Resistance	≥ 5000MΩ																
Dielectric Withstanding Voltage (at sea level)	500 V rms, 50Hz																
Working Voltage (at sea level)	150 V rms, 50Hz																
RF Leakage	≥ 90dB to 1GHz																
<table border="0"> <tr> <td data-bbox="132 1003 531 1055">Mechanical Data</td> <td></td> </tr> <tr> <td data-bbox="132 1055 531 1104">Recommended coupling nut torque</td> <td data-bbox="794 1055 1481 1104">2.65 to 3.63 inch lbs</td> </tr> <tr> <td data-bbox="132 1104 531 1153">Coupling proof torque</td> <td data-bbox="794 1104 1481 1153">6.2 inch lbs</td> </tr> <tr> <td data-bbox="132 1153 531 1202">Contact Captivation-axial</td> <td data-bbox="794 1153 1481 1202">≥ 2.25 lbs</td> </tr> <tr> <td data-bbox="132 1202 531 1252">Durability (mating)</td> <td data-bbox="794 1202 1481 1252">≥ 500</td> </tr> </table>		Mechanical Data		Recommended coupling nut torque	2.65 to 3.63 inch lbs	Coupling proof torque	6.2 inch lbs	Contact Captivation-axial	≥ 2.25 lbs	Durability (mating)	≥ 500						
Mechanical Data																	
Recommended coupling nut torque	2.65 to 3.63 inch lbs																
Coupling proof torque	6.2 inch lbs																
Contact Captivation-axial	≥ 2.25 lbs																
Durability (mating)	≥ 500																
<table border="0"> <tr> <td data-bbox="132 1361 531 1413">Environmental Data</td> <td></td> </tr> <tr> <td data-bbox="132 1413 531 1462">Temperature Range</td> <td data-bbox="794 1413 1481 1462">-55°C to +105°C</td> </tr> <tr> <td data-bbox="132 1462 531 1512">Thermal shock</td> <td data-bbox="794 1462 1481 1512">MIL-STD-202, Method 107, Condition B</td> </tr> <tr> <td data-bbox="132 1512 531 1561">Moisture resistance</td> <td data-bbox="794 1512 1481 1561">MIL-STD-202, Method 106</td> </tr> <tr> <td data-bbox="132 1561 531 1610">Corrosion</td> <td data-bbox="794 1561 1481 1610">MIL-STD-202, Method 101, Condition B</td> </tr> <tr> <td data-bbox="132 1610 531 1659">RoHS</td> <td data-bbox="794 1610 1481 1659">Compliant</td> </tr> </table>		Environmental Data		Temperature Range	-55°C to +105°C	Thermal shock	MIL-STD-202, Method 107, Condition B	Moisture resistance	MIL-STD-202, Method 106	Corrosion	MIL-STD-202, Method 101, Condition B	RoHS	Compliant				
Environmental Data																	
Temperature Range	-55°C to +105°C																
Thermal shock	MIL-STD-202, Method 107, Condition B																
Moisture resistance	MIL-STD-202, Method 106																
Corrosion	MIL-STD-202, Method 101, Condition B																
RoHS	Compliant																

Notice: JYEBAO reserves the right to make modifications deemed appropriate.