

ADS-1.0/3-1.0/3-1.4

1.0mm Plug To 1.0mm Plug  
110GHz VSWR 1.4

50Ω

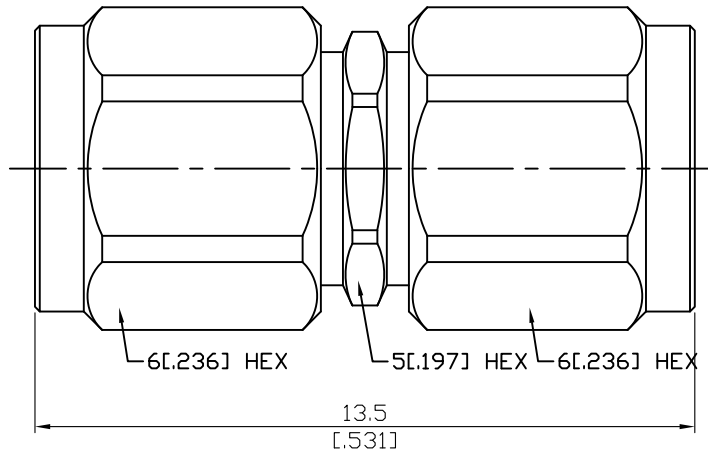

Parts	Material	Plating ( Micro-inch )
Body	Stainless Steel	Passivated
Coupling Nut	Stainless Steel	Passivated
Contact Pin	Beryllium Copper	Gold 4 Over Nickel-Phosphorus Alloy 80 Over Copper 20
Insulator	PPO	
Retainer Ring	Beryllium Copper	Tin-Zinc-Copper-Alloy 100 Over Copper 50
Gasket	Silicone	

This part number complies with RoHS.

Notice: JYEBAO reserves the right to make modifications deemed appropriate.

ADS-1.0/3-1.0/3-1.4	1.0mm Plug To 1.0mm Plug 110GHz VSWR 1.4																
<table border="0"> <tr> <td data-bbox="132 342 531 394"><b>Interface</b></td> <td></td> </tr> <tr> <td data-bbox="132 394 531 488">Standard</td> <td data-bbox="794 394 1482 488">IEC61169-31</td> </tr> </table>		<b>Interface</b>		Standard	IEC61169-31												
<b>Interface</b>																	
Standard	IEC61169-31																
<table border="0"> <tr> <td data-bbox="132 510 531 562"><b>Electrical Data</b></td> <td></td> </tr> <tr> <td data-bbox="132 562 531 607">Impedance</td> <td data-bbox="794 562 1482 607">50Ω</td> </tr> <tr> <td data-bbox="132 607 531 651">Frequency Range</td> <td data-bbox="794 607 1482 651">DC to 110GHz</td> </tr> <tr> <td data-bbox="132 651 531 696">VSWR</td> <td data-bbox="794 651 1482 696">≤ 1.4 (DC to 110GHz)</td> </tr> <tr> <td data-bbox="132 696 531 741">Insulation Resistance</td> <td data-bbox="794 696 1482 741">≥ 5000MΩ</td> </tr> <tr> <td data-bbox="132 741 531 786">Dielectric Withstanding Voltage (at sea level)</td> <td data-bbox="794 741 1482 786">500 V rms, 50Hz</td> </tr> <tr> <td data-bbox="132 786 531 831">Working Voltage (at sea level)</td> <td data-bbox="794 786 1482 831">150 V rms, 50Hz</td> </tr> <tr> <td data-bbox="132 831 531 875">RF Leakage</td> <td data-bbox="794 831 1482 875">≥ 90dB to 1GHz</td> </tr> </table>		<b>Electrical Data</b>		Impedance	50Ω	Frequency Range	DC to 110GHz	VSWR	≤ 1.4 (DC to 110GHz)	Insulation Resistance	≥ 5000MΩ	Dielectric Withstanding Voltage (at sea level)	500 V rms, 50Hz	Working Voltage (at sea level)	150 V rms, 50Hz	RF Leakage	≥ 90dB to 1GHz
<b>Electrical Data</b>																	
Impedance	50Ω																
Frequency Range	DC to 110GHz																
VSWR	≤ 1.4 (DC to 110GHz)																
Insulation Resistance	≥ 5000MΩ																
Dielectric Withstanding Voltage (at sea level)	500 V rms, 50Hz																
Working Voltage (at sea level)	150 V rms, 50Hz																
RF Leakage	≥ 90dB to 1GHz																
<table border="0"> <tr> <td data-bbox="132 1003 531 1055"><b>Mechanical Data</b></td> <td></td> </tr> <tr> <td data-bbox="132 1055 531 1099">Recommended coupling nut torque</td> <td data-bbox="794 1055 1482 1099">2.65 to 3.63 inch lbs</td> </tr> <tr> <td data-bbox="132 1099 531 1144">Coupling proof torque</td> <td data-bbox="794 1099 1482 1144">6.2 inch lbs</td> </tr> <tr> <td data-bbox="132 1144 531 1189">Contact Captivation-axial</td> <td data-bbox="794 1144 1482 1189">≥ 2.25 lbs</td> </tr> <tr> <td data-bbox="132 1189 531 1234">Durability (mating)</td> <td data-bbox="794 1189 1482 1234">≥ 500</td> </tr> </table>		<b>Mechanical Data</b>		Recommended coupling nut torque	2.65 to 3.63 inch lbs	Coupling proof torque	6.2 inch lbs	Contact Captivation-axial	≥ 2.25 lbs	Durability (mating)	≥ 500						
<b>Mechanical Data</b>																	
Recommended coupling nut torque	2.65 to 3.63 inch lbs																
Coupling proof torque	6.2 inch lbs																
Contact Captivation-axial	≥ 2.25 lbs																
Durability (mating)	≥ 500																
<table border="0"> <tr> <td data-bbox="132 1361 531 1413"><b>Environmental Data</b></td> <td></td> </tr> <tr> <td data-bbox="132 1413 531 1458">Temperature Range</td> <td data-bbox="794 1413 1482 1458">-55°C to +105°C</td> </tr> <tr> <td data-bbox="132 1458 531 1503">Thermal shock</td> <td data-bbox="794 1458 1482 1503">MIL-STD-202, Method 107, Condition B</td> </tr> <tr> <td data-bbox="132 1503 531 1547">Moisture resistance</td> <td data-bbox="794 1503 1482 1547">MIL-STD-202, Method 106</td> </tr> <tr> <td data-bbox="132 1547 531 1592">Corrosion</td> <td data-bbox="794 1547 1482 1592">MIL-STD-202, Method 101, Condition B</td> </tr> <tr> <td data-bbox="132 1592 531 1637">RoHS</td> <td data-bbox="794 1592 1482 1637">Compliant</td> </tr> </table>		<b>Environmental Data</b>		Temperature Range	-55°C to +105°C	Thermal shock	MIL-STD-202, Method 107, Condition B	Moisture resistance	MIL-STD-202, Method 106	Corrosion	MIL-STD-202, Method 101, Condition B	RoHS	Compliant				
<b>Environmental Data</b>																	
Temperature Range	-55°C to +105°C																
Thermal shock	MIL-STD-202, Method 107, Condition B																
Moisture resistance	MIL-STD-202, Method 106																
Corrosion	MIL-STD-202, Method 101, Condition B																
RoHS	Compliant																

Notice: JYEBAO reserves the right to make modifications deemed appropriate.